

NOTE:
CONTRACTOR TO VERIFY ALL SIZES ON SITE BEFORE COMMENCEMENT.

NOTE:
PLEASE DO NOT SCALE FROM THIS DRAWING.

NOTE:
Materials to match existing.
These notes do not comprise a full specification. They are for general guidance only and their primary function is to assist local authority officers in determining building regulation compliance. All dimensions must be checked on site prior to works starting. Do not scale. All works must be carried out in accordance with current building regulations, codes of practice and planning officers requirements. All materials must comply with current British standards in situations used.

FINISHES:
9.5mm plasterboard / skim finish to walls and 12.5mm plasterboard / skim finish to ceilings. Floors to be tongue and groove chipboard. Skirtings and architraves to match existing. Fascias and soffits to match existing.

All non load bearing partitions to be 75mm x 50mm studwork at 600mm max. centres with 12.5mm plasterboard and skim finish. Partitions to have 75mm mineral wool sound insulation quilt between uprights. (double up joist under partitions)

All decorative finishes to be agreed with owner for pricing purposes.

Include generally for making good all surfaces inside and out including decorative finishes.

Kitchen layout to clients own choice.

REV A: ALTERED CEILING TIES TO 150 X 50MM TO SUITE BUILDING REG COMMENTS 23/05/06

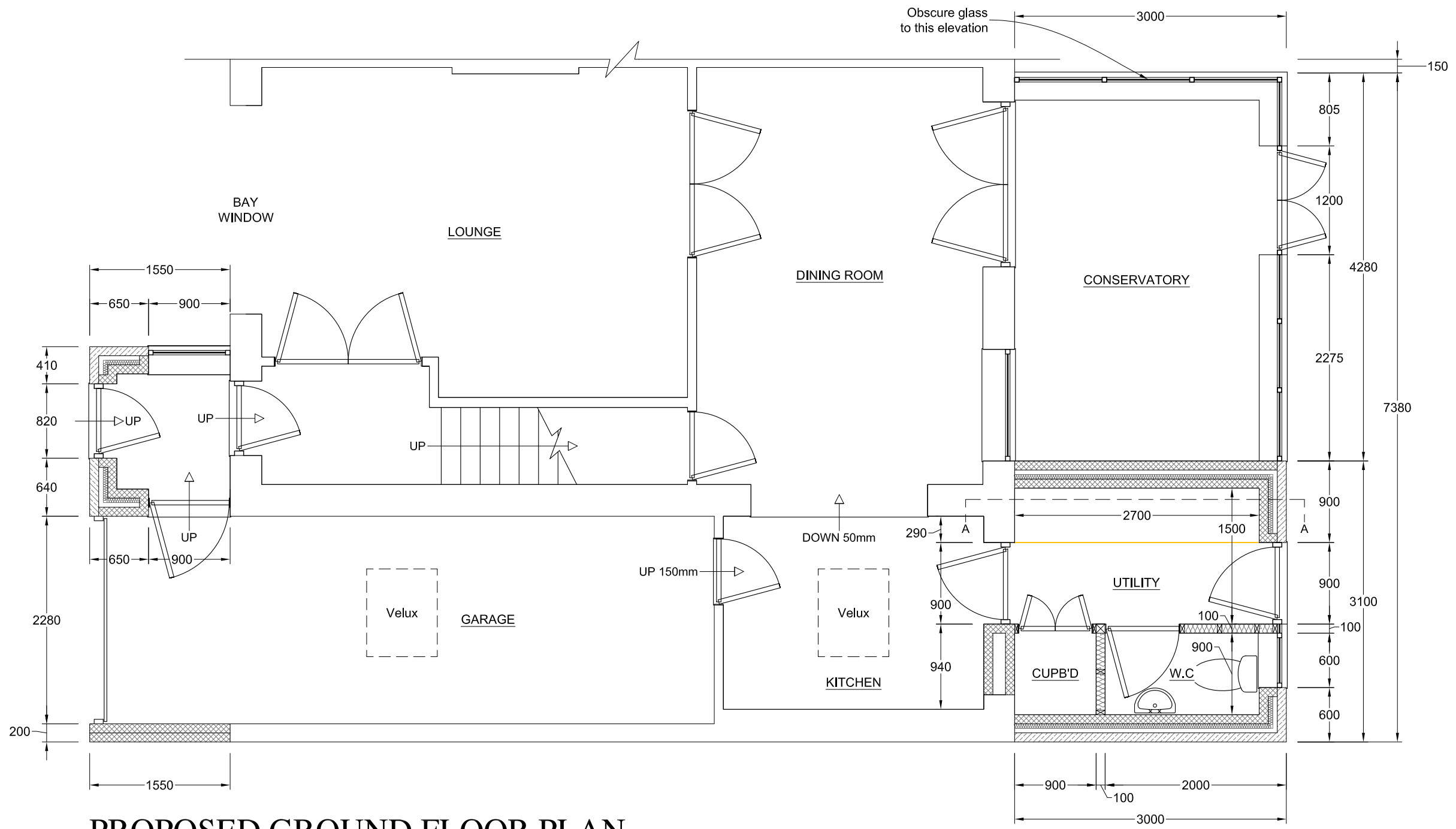

PROPOSED GROUND FLOOR PLAN

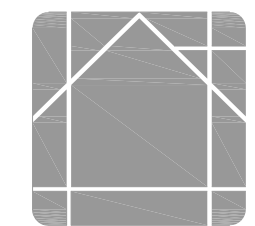

MASDESIGN
Consultants Ltd
www.masdesignconsultants.com
T 01943 878398
22 Granville Terrace, Guiseley, Leeds, LS20 9DY

EXTENT OF PROJECT:
PROPOSED SINGLE STOREY REAR EXTENSION FORMING UTILITY & CONSERVATORY, PROPOSED PORCH & NEW PITCHED ROOF TO GARAGE/ KITCHEN

CLIENT DETAILS:
15 QUEEN STREET
RAWDON
LEEDS
LS19 6BG

DRAWING TITLE:
PROPOSED FIRST FLOOR PLAN

PAPER SIZE	SCALE	DATE	DRAWING No
A3	1:50	18/04/06	