

**NOTE:**  
CONTRACTOR TO VERIFY ALL SIZES ON SITE BEFORE COMMENCEMENT.

**NOTE:**  
PLEASE DO NOT SCALE FROM THIS DRAWING.

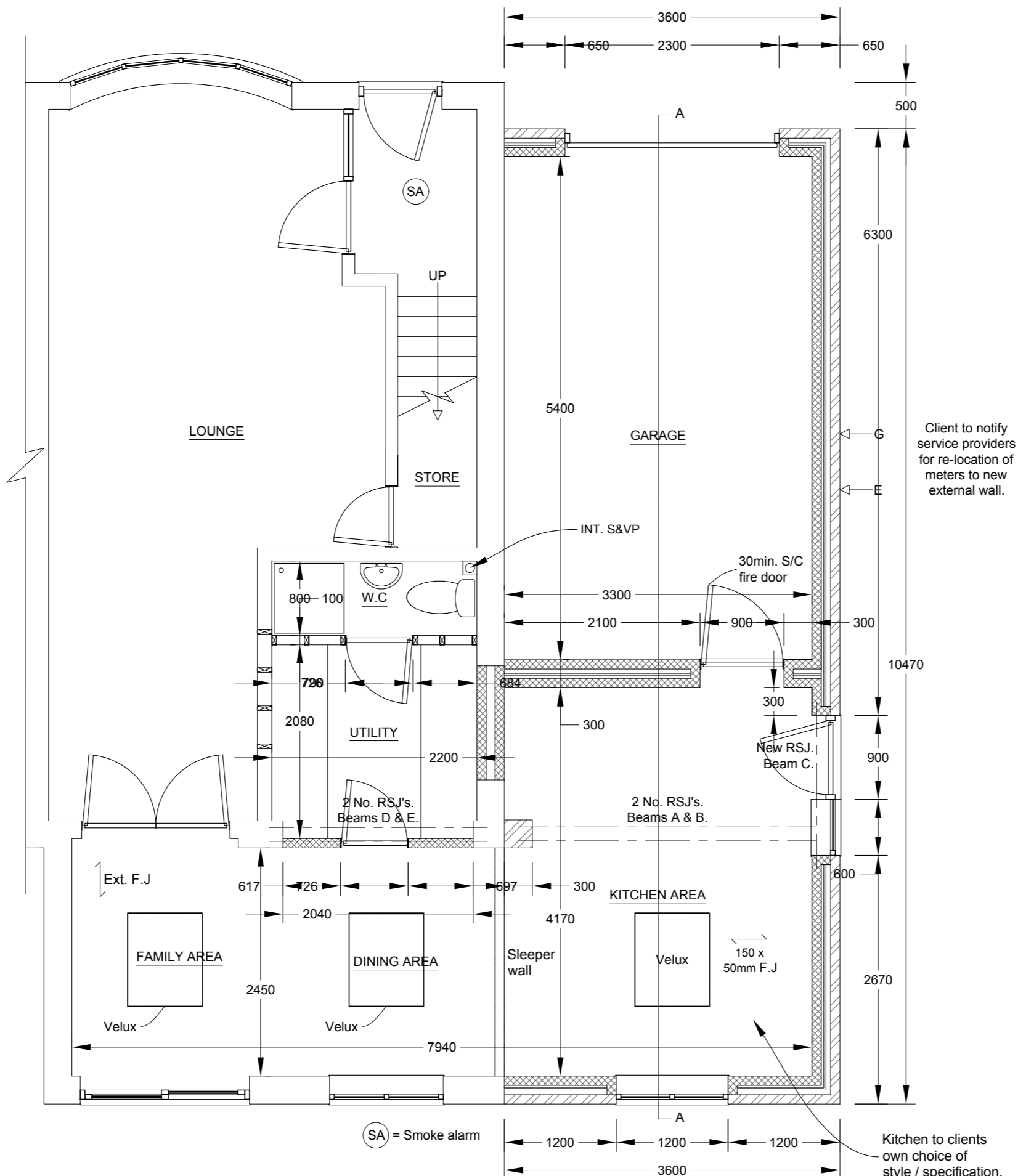

**NOTE:**  
Materials to match existing.  
These notes do not comprise a full specification. They are for general guidance only and their primary function is to assist local authority officers in determining Building Regulation Compliance. All dimensions must be checked on site prior to works starting. Do not scale.  
All works must be carried out in accordance with current Building Regulations, Codes of Practice and Planning Officers requirements. All materials must comply with current British Standards in situations used.

**STEELWORK:**  
Steelwork RSJ's to engineers design and calculations; sat on concrete padstones (conditional approval requested for Building Regulation Compliance. Calculations to be submitted prior to work starting on site) Maintain 150mm bearing capacity. Clad steelwork with 15mm fire line plasterboard to give 30 minutes fire resistance. (Drawings to be read in conjunction with engineering details)

REV A: STRUCTURAL DETAILS ADDED 18/06/08



**MAS DESIGN**  
Consultants Ltd  
www.masdesignconsultants.com  
T 01943 878398  
22 Granville Terrace, Guiseley, Leeds, LS20 9DY

**EXTENT OF PROJECT:**  
PROPOSED TWO STOREY SIDE/ SINGLE STOREY REAR EXTENSION

**CLIENT DETAILS:**  
2 TRINITY RISE  
OTLEY  
LEEDS  
WEST YORKSHIRE

<b>DRAWING TITLE:</b> PROPOSED GROUND FLOOR PLAN			
PAPER SIZE	SCALE	DATE	DRAWING No
A3	1:50	18/12/07	

# PROPOSED GROUND FLOOR PLAN

**NOTE:**  
CONTRACTOR TO VERIFY ALL SIZES ON SITE BEFORE COMMENCEMENT.

**NOTE:**  
PLEASE DO NOT SCALE FROM THIS DRAWING.

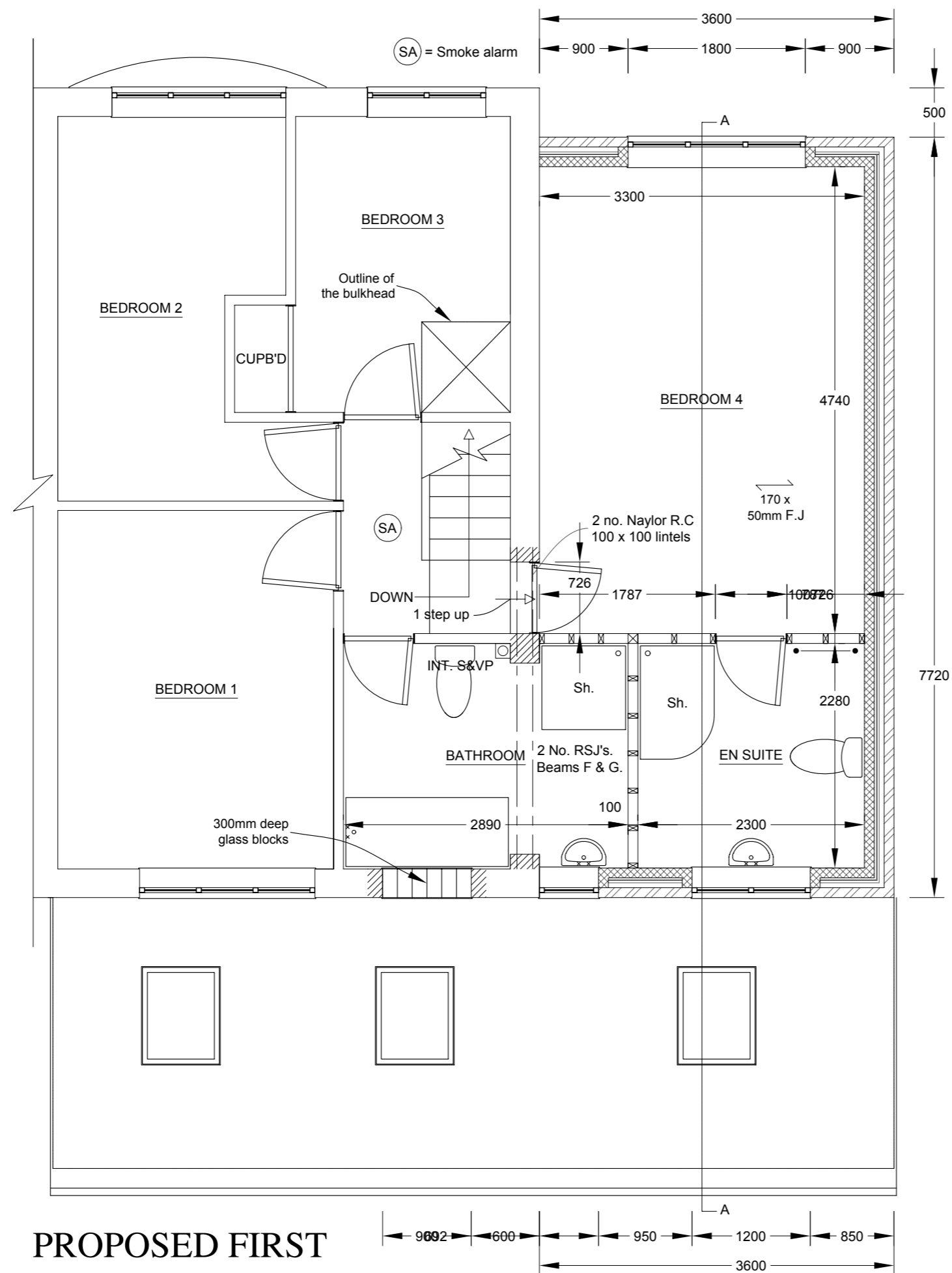

**NOTE:**  
Materials to match existing.  
These notes do not comprise a full specification. They are for general guidance only and their primary function is to assist local authority officers in determining Building Regulation Compliance. All dimensions must be checked on site prior to works starting. Do not scale.  
All works must be carried out in accordance with current Building Regulations, Codes of Practice and Planning Officers requirements. All materials must comply with current British Standards in situations used.

**FINISHES:**  
9.5mm plasterboard and skim finish to walls.  
12.5mm plasterboard and skim finish to ceilings.  
Floors to be tongue and groove chipboard.  
Skirtings and architraves to match existing.  
Fascias to match existing.

All non load bearing partitions to be 75mm x 50mm studwork at 600mm max. centres with 12.5mm plasterboard and skim finish. Partitions to have 75mm mineral wool sound insulation quilt between uprights.

All decorative finishes to be agreed with owner for pricing purposes.

Include generally for making good all surfaces inside and out including decorative finishes.

REV A: STRUCTURAL DETAILS ADDED 18/06/08



**MAS DESIGN**  
Consultants Ltd

www.masdesignconsultants.com

T 01943 878398

22 Granville Terrace, Guiseley, Leeds, LS20 9DY

**EXTENT OF PROJECT:**  
PROPOSED TWO STOREY SIDE/ SINGLE STOREY REAR EXTENSION

**CLIENT DETAILS:**  
2 TRINITY RISE  
OTLEY  
LEEDS  
WEST YORKSHIRE

**DRAWING TITLE:**  
PROPOSED FIRST FLOOR PLAN

PAPER SIZE	SCALE	DATE	DRAWING No
A3	1:50	18/12/07	

**PROPOSED FIRST FLOOR PLAN**